



## “BDZ6” Running Tools

The “**BDZ6**” **Running Tools** are used to install BDDB Locks and attached subsurface control devices in 4” to 7” no-go landing nipples with BDDB profiles.

The BDZ6 Running Tool consists of a fishing neck with a threaded pin connection on the upper end, a plunger, a plunger ring, a lock pin retainer and a garter spring. The lock pin retainer provides a means of securing the setting pin remnants in the BDZ6 and is fitted with an internal thread where hollow prongs can be fitted for equalizing operations, while the garter spring serves as a ‘telltale’ device to provide a positive indication that the lock has been set correctly.

The lock is attached to the BDZ6 Running Tool plunger and plunger ring with shear pins. There are two sets of pins on the BDZ6, the lower pins are for setting the device and shear during the jarring down process. The upper pins permit an over-pull to be taken to confirm correct setting of the device, upward jarring will shear these pins and release the BDZ6.

Nominal Size	Actual Size OD	Connection on Tool	Connection for Prong	Fish Neck	Shear Pin Diameter	Length
3.500”	3.000”	1-1/16” -10	3/4” -10	1.750”	5/16”	15.312”
4.000”	3.202”	1-9/16” -10	15/16” -10	2.313”	5/16”	14.500”
5.500”	4.015”	1-9/16” -10	15/16” -10	2.313”	5/16”	14.031”
7.000”	5.313”	1-9/16” -10	1 1/2” 11LP	2.313”	5/16”	14.750”

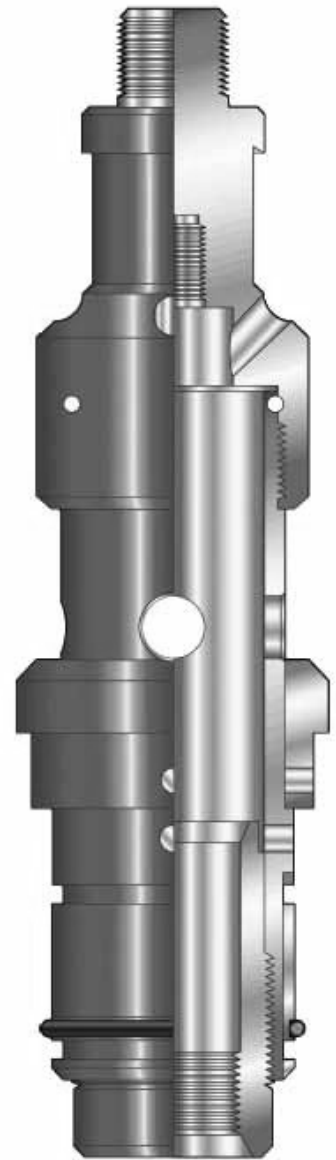

**BDZ6**  
**Running Tool**

For retrieval of BDZ6 Running Tool, retrieval tools are available.

Please contact our BDWS Sales representative.